

Top View

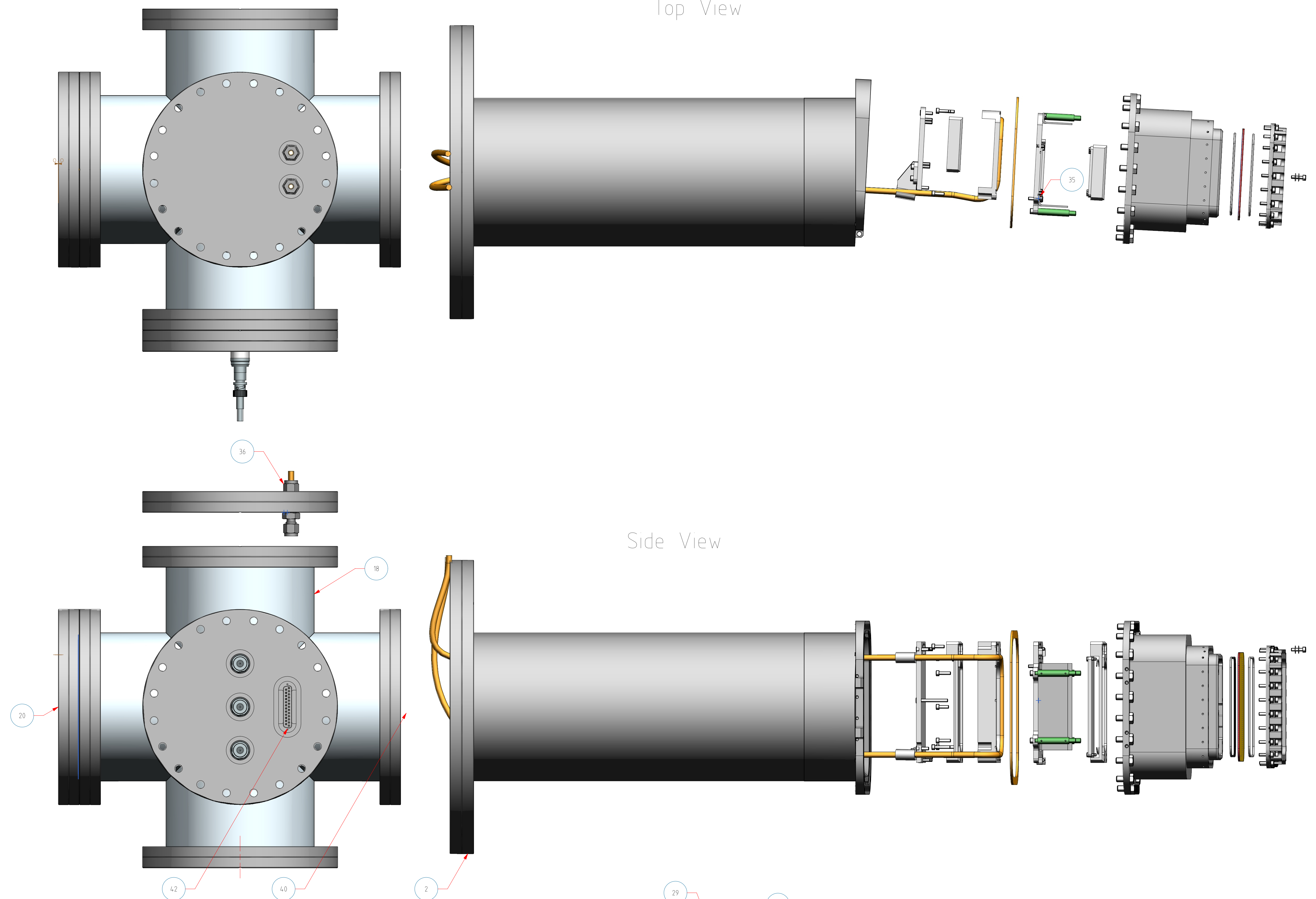

Side View

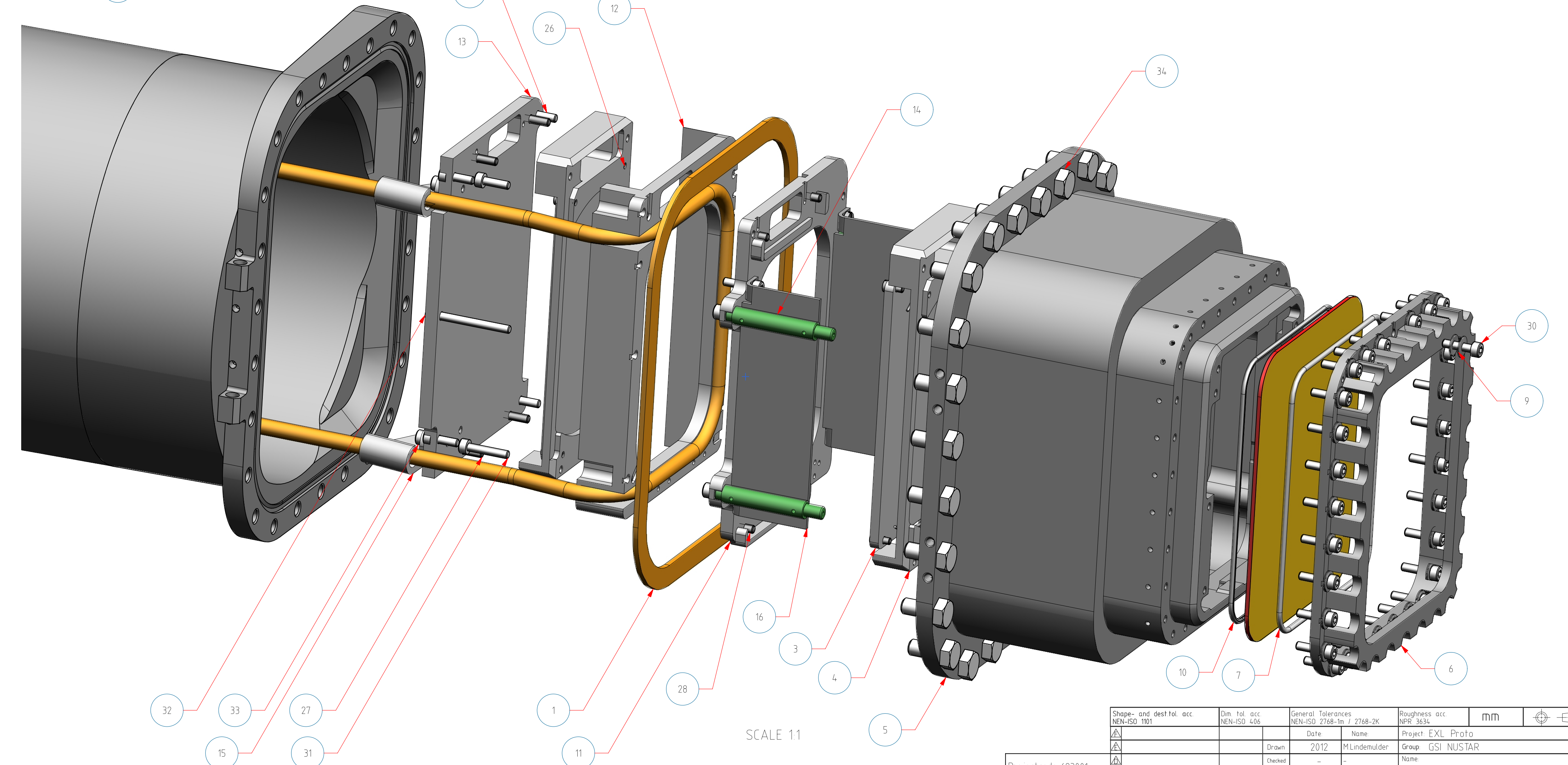
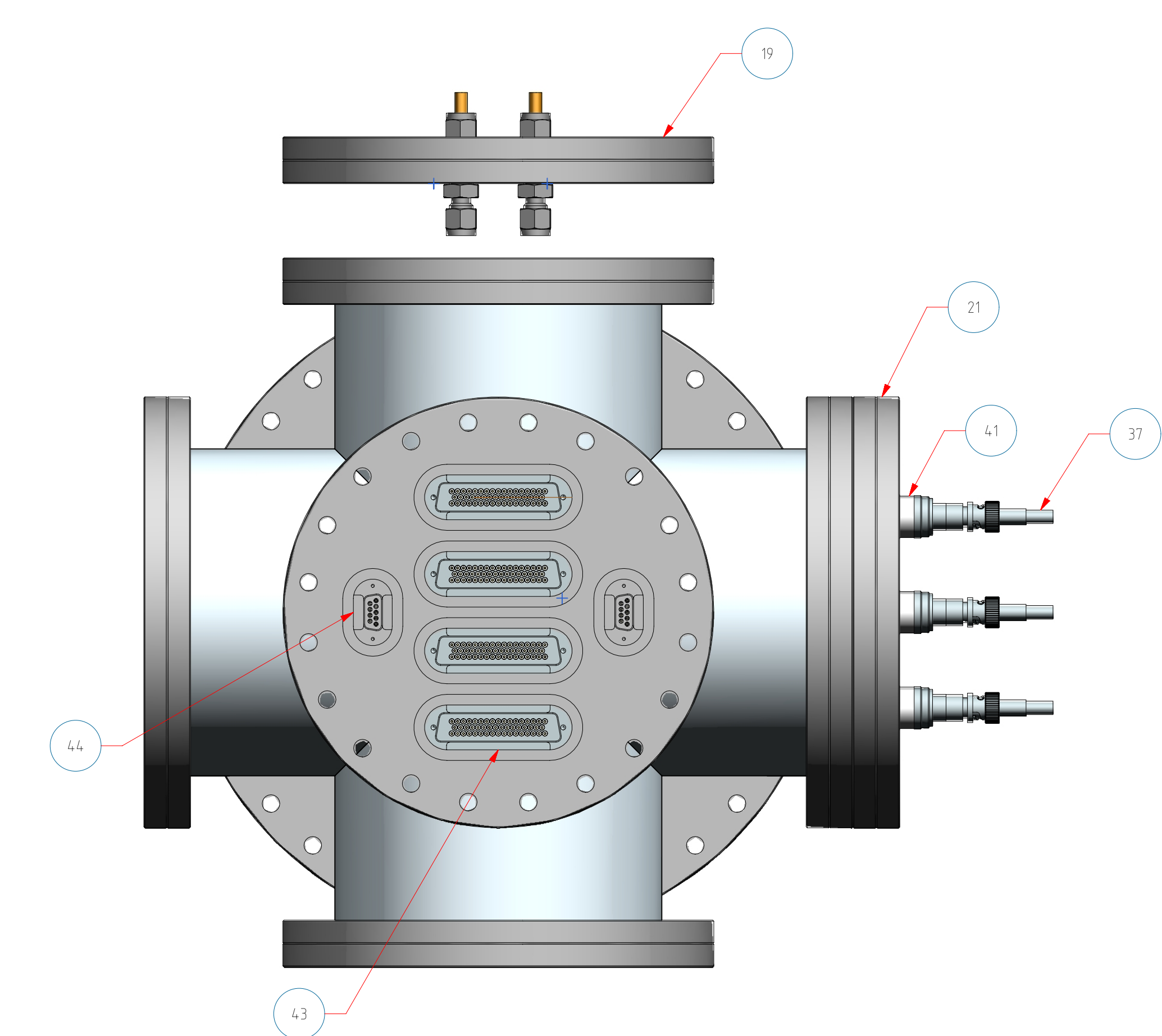

SCALE 1:1

| No. | QTY | Part No.                        | Description             | Material | Remarks |
|-----|-----|---------------------------------|-------------------------|----------|---------|
| 44  | 2   | VACOM W-SUBD-0-DE-CE-550        | needs to be ordered     |          |         |
| 43  | 4   | VACOM W-SUBD-50-DE-CE-550       | needs to be ordered     |          |         |
| 42  | 1   | VACOM W-SUBD-25-DE-CE-550       | needs to be ordered     |          |         |
| 41  | 3   | VACOM W-SUBD-01-L-SE-CE-NI      | needs to be ordered     |          |         |
| 40  | 2   | VACOM P-LUG-SUBD-0-P-CL         | needs to be ordered     |          |         |
| 39  | 4   | VACOM P-LUG-SUBD-50-P-CL        | needs to be ordered     |          |         |
| 38  | 1   | VACOM P-LUG-SUBD-25-P-CL        | needs to be ordered     |          |         |
| 37  | 3   | VACOM P-LUG-SHYB                | needs to be ordered     |          |         |
| 36  | 2   | SS-WM-01                        | needs to be ordered     |          |         |
| 35  | 2   | D1N934 M3                       | in house                |          |         |
| 34  | 26  | D1N933 M6 X 14                  | silver plated (at GSF?) |          |         |
| 33  | 6   | D1N812 M3 X 8                   | in house                |          |         |
| 32  | 1   | D1N812 M3 X 30                  | in house                |          |         |
| 31  | 2   | D1N812 M3 X 16                  | in house                |          |         |
| 30  | 34  | D1N812 M3 X 12                  | silver plated (at GSF?) |          |         |
| 29  | 7   | D1N812 M3 X 10                  | in house                |          |         |
| 28  | 5   | D1N84 M3 X 6                    | in house                |          |         |
| 27  | 4   | D1N84 M3 X 10                   | in house                |          |         |
| 26  | 16  | D1N84 M2,5 X 6                  | in house                |          |         |
| 25  | 6   | D1N84 M2 X 6                    | in house                |          |         |
| 24  | 8   | D1N7991 M2,5 X 12               | in house                |          |         |
| 23  | 4   | D1N7991 M2 X 10                 | in house                |          |         |
| 22  | 2   | D1N1254 M2                      | in house                |          |         |
| 21  | 1   | 31100312000-06-CP-DN150-BF      | needs to be ordered     |          |         |
| 20  | 1   | 31100312000-04-CP-DN150-BF      | needs to be ordered     |          |         |
| 19  | 1   | 31100312000-01-CP-DN150-BF      | needs to be ordered     |          |         |
| 18  | 1   | 31100312000                     | at GSF?                 |          |         |
| 17  | 1   | 31100311480-07-COOL TUBE        | ordered by KVI          |          |         |
| 16  | 2   | 31100311480-06-RADIATION SHIELD | produced                |          |         |
| 15  | 2   | 31100311480-05-HOSE ROUTER      | produced                |          |         |
| 14  | 4   | 31100311480-04-PISTON ROD       | produced                |          |         |
| 13  | 1   | 31100311480-03-SIL1 SUP-2       | produced                |          |         |
| 12  | 1   | 31100311480-02-SMNDWTPART       | produced                |          |         |
| 11  | 1   | 31100311480-01-SIL1 SUP-1       | produced                |          |         |
| 10  | 1   | 31100311440-12-DELTA SEAL       | at GSF                  |          |         |
| 9   | 60  | 31100311440-11-DISSPRING        | ordered by GSF          |          |         |
| 8   | 8   | 31100311440-04-DISSD            | at GSF                  |          |         |
| 7   | 1   | 31100311440-03-WIRE             | at GSF                  |          |         |
| 6   | 1   | 31100311440-02-PRESS PART       | in production KVI       |          |         |
| 5   | 1   | 31100311440-01-DISSD HOUSING    | produced                |          |         |
| 4   | 2   | 31100311411-02-DUMMY SIL1       | in production KVI       |          |         |
| 3   | 2   | 31100311411-01-SIL1 DUMMY       | in production KVI       |          |         |
| 2   | 1   | 31100311300-BACK POCKET D       | produced                |          |         |
| 1   | 1   | 31100311000-01-CP COPPER SEAL   | produced                |          |         |

| Sheep- und des/haec doc | Doc No | General Tolerances   | Surface doc | mm | Scale                          |
|-------------------------|--------|--|-------------|----|--------------------------------|
| HEAT TEST               | 3103   | ISO 2768   | ISO 2768    | mm | 1:1                            |
| Drawn                   | 2012   | ISO 2768   | None        | mm | A0                             |
| Projectcode             | 623001 |  |             |    |                                |
| Werkorder               | G5003  |  |             |    |                                |
| Dimensions              | LV&H   |  |             |    |                                |
| Material                |        |  |             |    |                                |
| Mass [kg]               |        |  |             |    |                                |
| Revision                | Date   | Zentraleinheit 25-60-30-320-4001-4001-1000-2000-2000-4000 [mm]<br>+0.1 ± 0.2 ± 0.3 ± 0.5 ± 0.8 ± 1.2 |             |    | Sheet 12                       |
|                         |        | Kernforschungsanstalt Karlsruhe<br>+49 (0) 91 935 3549 / www.kfz.fzj.de                              |             |    | 3,1003,0000,HeatTest_setup.dwg |
|                         |        | Drawing number   |             |    | 11                             |
|                         |        | Drawing name   |             |    | HeatTest setup                 |